



# Alfa Laval TZ-750

## Fast, Effective Impact Cleaning

### Application

The Toftejorg TZ-750 rotary jet head provides 3D indexed impact cleaning over a defined time period. It is automatic and represents a guaranteed means of achieving quality assurance in tank cleaning. The device is suitable for storage and transportation tanks and vessels between 3,000 and 7,000 m<sup>3</sup>. Used in chemical processing and the pulp and paper industries.

### Working principle

The flow of the cleaning fluid makes the nozzles perform a geared rotation around the vertical and horizontal axes. In the first cycle, the nozzles lay out a coarse pattern on the tank surface. The subsequent cycles gradually make the pattern more dense, until a full pattern is reached after 4 cycles.

### Standard Design

The choice of nozzle diameters can optimise jet impact length and flow rate at the desired pressure. As standard documentation, the Toftejorg TZ-750 can be supplied with a "Declaration of Conformity" for material specifications.



### TECHNICAL DATA

Lubricant: . . . . . Self-lubricating with the cleaning fluid  
 Standard surface finish: . . . . . Ra 0.5µm exterior  
 Flow rate: . . . . . 38 - 83 m<sup>3</sup>/h  
 Max. throw length: . . . . . 30 - 40 m  
 Min. required passage: . . . . . See dimension drawings

### Pressure

Working pressure: . . . . . 5 - 12 bar  
 Recommended pressure: . . . . . 5 - 10 bar

### Cleaning Pattern

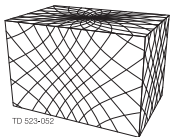

First cycle

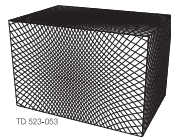

Full pattern

The above drawings show the cleaning pattern achieved on a horizontal vessel. The difference between the first cycle and the full pattern represents the number of additional cycles available to increase the density of the cleaning.

### Certificates

2.1 material certificate and ATEX.

### PHYSICAL DATA

#### Materials

316L (UNS S31603), 1.4401, PTFE, PVDF, Carbon, EFTE.

#### Temperature

Max. working temperature: . . . . . 95°C  
 Max. ambient temperature: . . . . . 140°C

#### Weight

Portable: . . . . . 12.1 kg  
 Fixed: . . . . . 3.6 kg

#### Connections

Standard thread: . . . . . 2½" Rp (BSP), NPT

#### Caution

Avoid hydraulic shock, hard and abrasive particles in the cleaning liquid, as this can cause increased wear and/or damage of internal mechanisms. In general, a filter in the supply line is recommended. Do not use for gas evacuation or air dispersion. For steaming we refer to the manual.



**Flow Rate** Nozzles mm

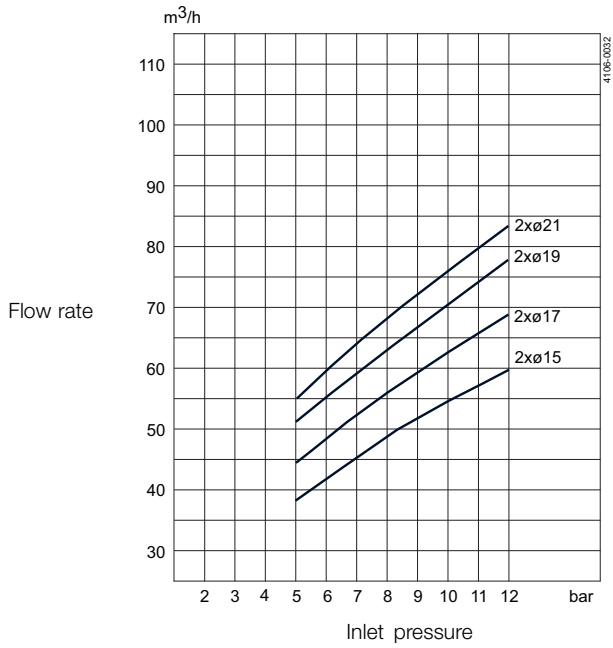

**Horizontal Throw Length (Wetting Radius) at Static Condition** Nozzles mm

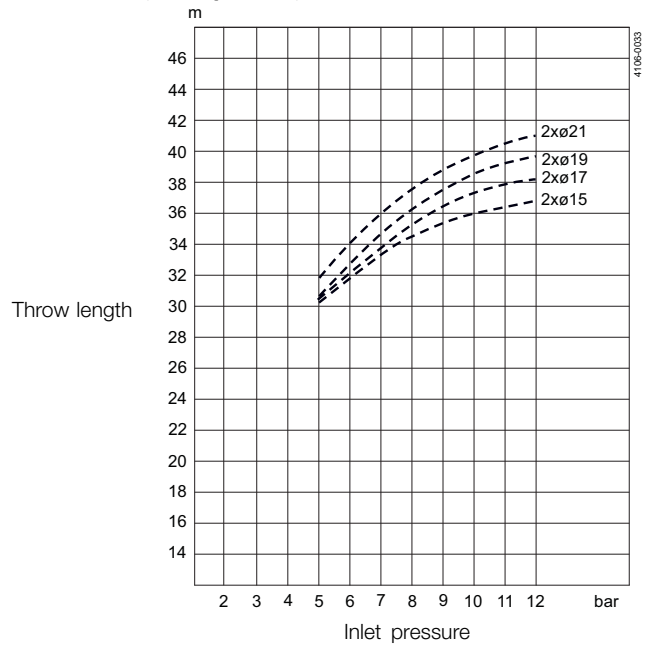

**Dimensions (mm)**

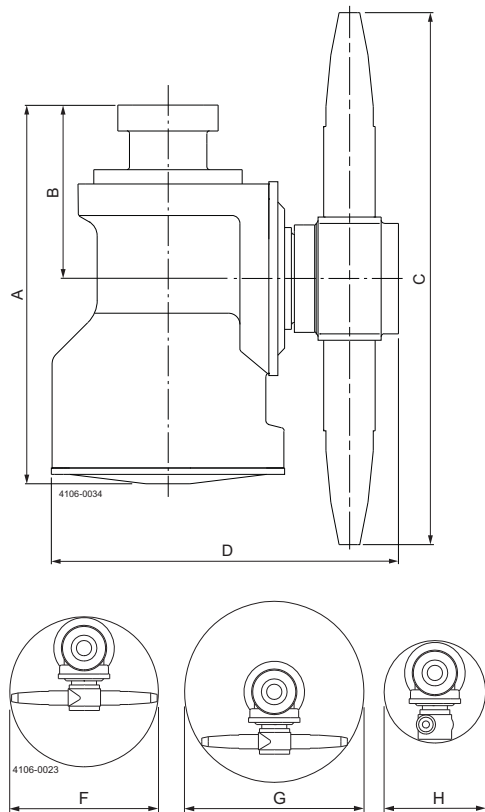

**Cleaning Time, Complete Pattern** Min. RPM of machine body Nozzles mm  
PTM (Pattern time minutes)

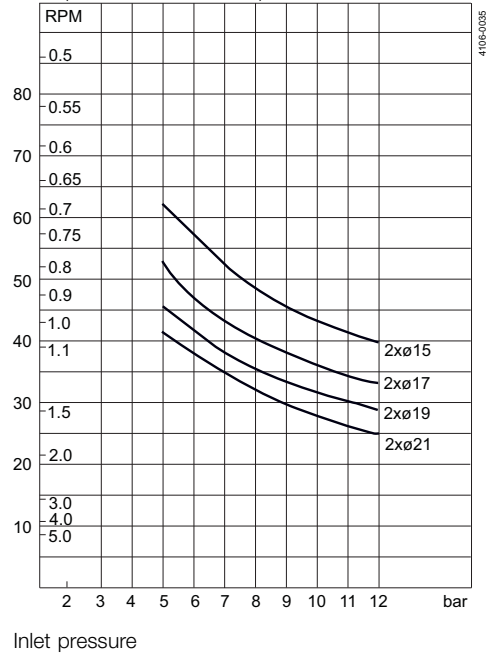

A	B	C	D	F	G	H
242	110	337	220	ø343	ø424	ø223

Alfa Laval reserves the right to change specifications without prior notification.

---

**How to contact Alfa Laval**

Contact details for all countries are continually updated on our website. Please visit [www.alfalaval.com](http://www.alfalaval.com) to access the information direct.